



CM

TRUCK BEDS®

2023 PARTS BOOK



PARTS BOOK OUR MISSION

CM Truck Beds is America's leader in flat deck truck bodies. One of the most important facets of buying a truck body is having the right parts to install the body. At CM Truck Beds, we have the parts you need to get the job done right. From install kits, wiring harnesses, and all aftermarket parts in between, we carry a wide variety of aftermarket truck equipment parts suitable for any upfit. Whether you are installing a bed, want aftermarket parts, or need to complete a repair, we carry the right solutions for you. We also offer many parts that fit other brands of flat deck and service bodies.

Should you have any questions about our parts or part fitment, don't hesitate to pick up the phone and reach out to our experienced team of parts professionals. Our knowledgeable staff stands ready to assist you in getting the right parts, on-time.

For questions, please contact us at 580.564.7537 or parts@cmtruckbeds.com.

PARTS BOOK

TABLE OF CONTENTS

LIGHTING ■ LED's, Grommets, Trim Rings	1
CAST HOUSINGS, FUEL, FENDERS, TIEDOWNS ■ Light Housing, Fuel Fills, Fenders, Tiedowns	2
ROADWAY PROTECTION ■ Fender Mounts, Mudflaps, Side Rails, Panels, etc.	3-5
LIFTING EQUIPMENT ■ Cranes, Hydraulic Accessories, Hoists, etc.	7
INSTALLATION KITS ■ Ford, GM, RAM, Universal	8
ADAPTERS & WIRING HARNESSSES ■ OEM Specific Adapters, Complete Harnesses, Trailer Plugs	9-11
HITCHES ■ Receivers, Fifth Wheel, Replacement Bumper/Receiver, Turnover Balls	12
TOOLBOX EQUIPMENT ■ CTech, American Eagle, Equipto Drawers, Shelving, Latches, etc.	13-15
DOORS & FABRICATED ASSEMBLY ■ Product Assembly Breakdown, Quick Quote Reference Page	16-20

LIGHTS



LED LIGHTS ■ BULLET LIGHTS ■ REFLECTION STICKERS ■ WORK LIGHTS

Ref. #	Part No.	Description	Ref. No.	Part No.	Description
1	8100367	6" Oval S-T-T Red Lens 6 Diode	-	8101534	¾" LED Bullet DOT Light - Amber
2	8101516	6" Oval S/T/T Clear Lens Red LED 6 Diode	9	8101905	¾" LED Bullet License Plate - White
-	8101085	6" Oval Clear Lens White LED 6 Diode	10	8101436	¾" Bullet Light Bezel - Chrome
4	8101562	6" Oval Flush Mount S/T/T Clear Lens Red LED 10 Diode	11	7181636	6"x4" LED Work Light with Chrome Trim
-	121697	6" Oval Flush Mount Clear Lens White LED 10 Diode	12	8101560	18W/1170LM LED Flood Light
5	8100387	6" Oval Grommet	13	119238	Adhesive Backed Reflector - Amber
6	118526	6" Chrome Bezel - For Flush Mount Lights	14	119239	Adhesive Backed Reflector - Red
7	7181585	4-Action Flush Mount Tail Light Assembly - SB	15	8101222	LED Tractor, Obsolete TM Worklight
8	8101535	¾" LED Bullet DOT Light - Red	16	7000584	Toggle Switch with Cup - 2 Wire

CAST HOUSINGS, FUEL, FENDERS, TIEDOWNS

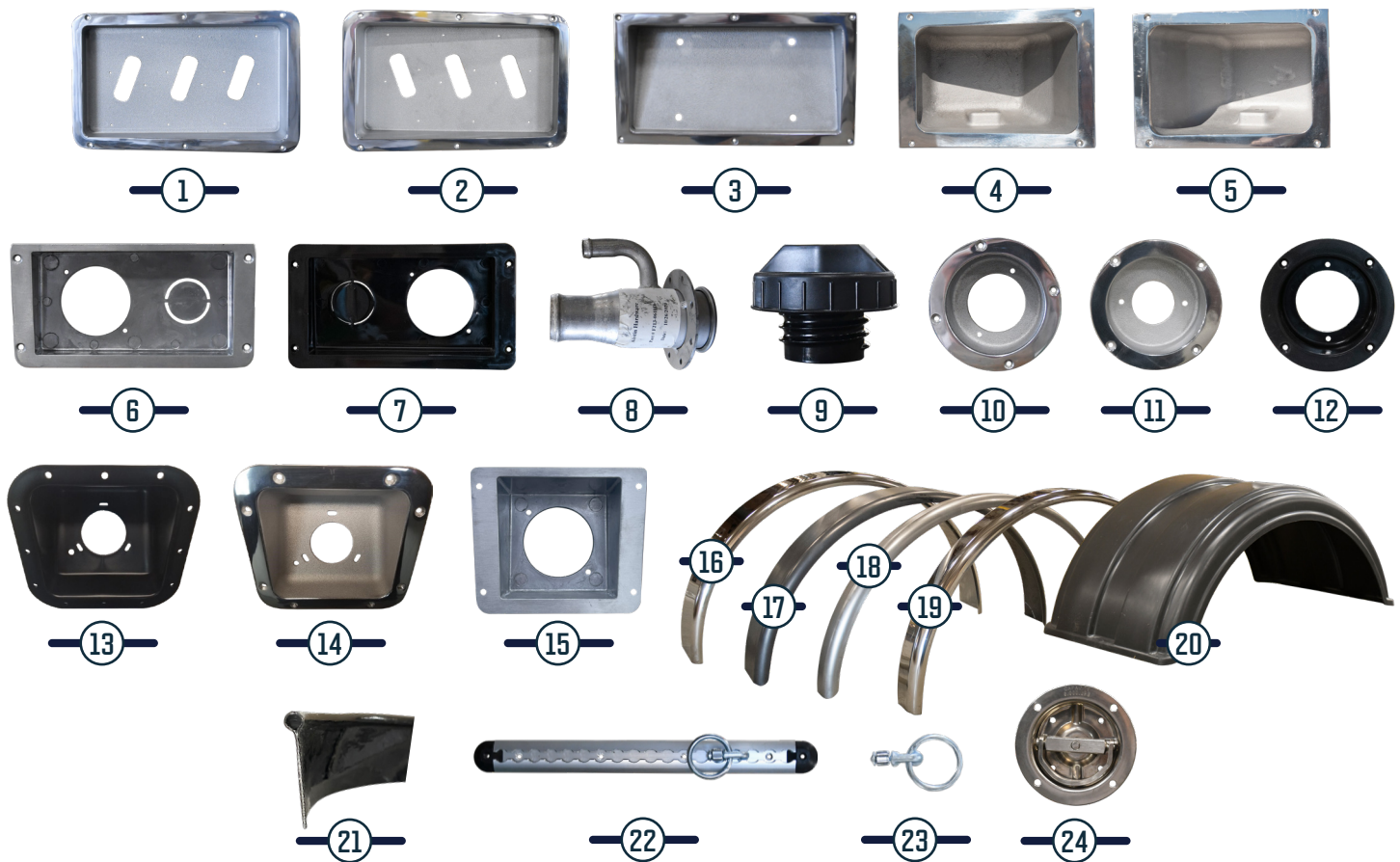

LIGHT HOUSINGS ■ FUEL FILLS ■ FUEL CAPS ■ TIE DOWNS ■ FENDERS					
Ref. No.	Part No.	Description	Ref. No.	Part. No.	Description
1	120803	Cast Aluminum Driver's Side Light Housing	15	9471812	Aluminum Fuel Fill, Square
2	120804	Cast Aluminum Passenger's Side Light Housing	16	119384	5" Stainless Steel Fender - Actual Measurement - 6" x 37"
3	120561-B	Cast Aluminum License Plate Housing	17	118617	5" Steel Fender - Raw - Actual Measurement - 5" x 37"
4	121391	Cast Aluminum Work Light Housing DS	18	114631	2" Steel Fender - Raw - Actual Measurement - 2" x 37"
5	121390	Cast Aluminum Work Light Housing PS	19	7050173	2" Stainless Steel Fender - Actual Measurement - 3" x 37"
6	9471782-C	Cast Aluminum Rectangle Fuel Fill/DEF	-	7050182	2" Aluminum Fender - Actual Measurement - 2" x 37"
7	9471781-C	Plastic Rectangle Fuel Fill/DEF	-	121831	5" Stainless Steel Fender - Actual Measurement - 6" x 45"
8	7200043	Cast Steel Fuel Neck - 2" OD Fuel - 3/4" OD Vent	20	7050812	DRW Poly Fender - Fender Only
9	7200051	Plastic Sealing Fuel Cap	-	5352810	Fender Mounting Brackets for DRW Poly Fender
10	120633	Cast Aluminum Fuel Fill - Round	21	946012	Welting Trim for Stainless Fenders
11	9470573	Cast Aluminum DEF Fill - Round	22	7181606	Airline Track Kit 18" with D-Ring
12	122131	Plastic Fuel Fill - Round	23	5351496	D-Ring Tiedown 2 1/4"
13	7200059	Fuel Fill Cup - 6" x 6" - Plastic	24	120307	Stainless Steel Tiedown 360 Degree
14	7200065	Fuel Fill Cup - 6" x 6" - Cast Aluminum			

ROADWAY PROTECTION



FENDER MOUNTS ■ BOLTS/NUTS ■ STRAPS ■ CLAMPS

Ref. No.	Part No.	Description	Ref No.	Part No.	Description
1	112945	SRW Mudflap Only with Logo	7	102617	1/2"-13 Steel Nylon Lock Nut
2	121061	SRW Mudflap Strap Only	-	7030534	1/2" Steel Washer
3	7180551	SRW Mudflap Bracket	8	120637	5/16"-18 x 1" Bolt
4	8300018	DRW Mudflap Only with Logo	-	118517	SRW Mudflap Kit with Logo - Flap, Bracket, Strap, Hardware
5	121062	DRW Mudflap Strap Only	-	118516	DRW Mudflap Kit with Logo - Flap, Bracket, Strap, Hardware
6	7180550	DRW Mudflap Bracket	9	5352810	Fender/Flap Mounting Bracket Kit

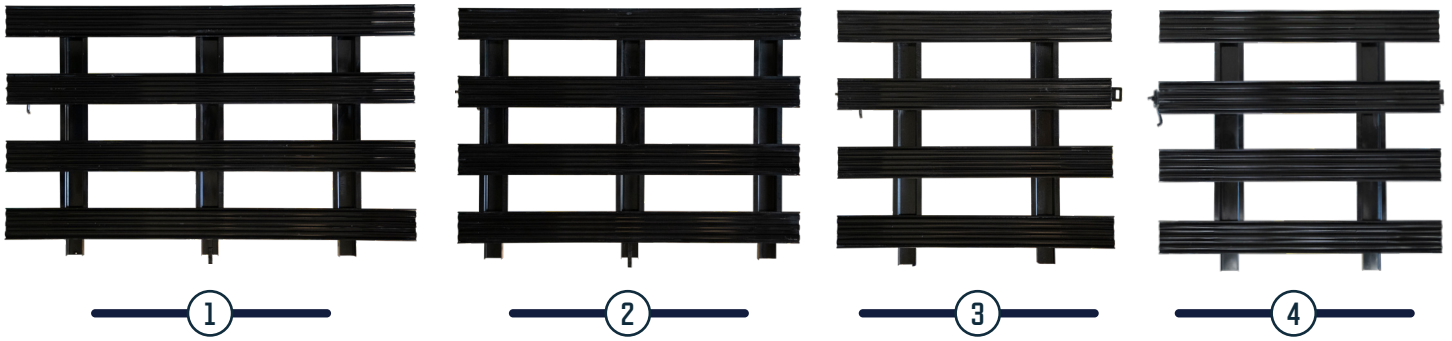

STAKESIDE PANELS & KITS

Ref. No.	Part No.	Description	Ref. No.	Part No.	Description
1	7180929	Stake Panel, 6' Side Panel	-	7180938	Stake Side Kit, 12' Set
2	7180928	Stake Panel, 5' Side Panel	-	7180935	Stake Side Kit, 14' Set
3	7180930	Stake Panel, 4' DS Gate	-	7180936	Stake Side Kit, 16' Set
4	7180931	Stake Panel, 4' PS Gate	-	7180937	Stake Side Kit, 20' Set
-	7180927	Stake Panel, 4' Side Panel	-	7180963	Stake Side Kit, 22' Set
-	7180966	Stake Side Kit, 11' Set	-	7180964	Stake Side Kit, 24' Set



STEEL DROP IN SIDE RAILS

Part No.	Description	Part No.	Description
121160	Steel Drop in Side Rails, 118", Fitment 11'4" x 97"	123487	Steel Drop in Side Rails, 92", Fitment 8'6" x 84"
121159	Steel Drop in Side Rails, 94", Fitment 9'4" x 97"	113500	Steel Drop in Side Rails, 85", Fitment 8'6" x 97"
		113456	Steel Drop in Side Rails, 74", Fitment 84" x 84"



ALUMINUM DROP IN SIDE RAILS

Part No.	Description	Part No.	Description
7180662	Aluminum Drop in Side Rails, Bolt Together, 6" Tall, Fitment 7' - 9'4"	7180660	Aluminum Drop in Side Rails, Bolt Together, 4" Tall, Fitment 11'4"
7180648	Aluminum Drop in Side Rails, Bolt Together, 4" Tall, Fitment 7' - 9'4"		



STEEL FOLD DOWN SIDE RAILS

Part No.	Description	Part No.	Description
7180656	Steel Fold Down Side Rail, 118" PWD, Complete Kit	7180654	Steel Fold Down Side Rail, 85" PWD, Complete Kit
7180655	Steel Fold Down Side Rail, 102" PWD, Complete Kit	7180667	Steel Fold Down Side Rail, 74" PWD, Complete Kit
7180652	Steel Fold Down Side Rail, 94" PWD, Complete Kit	7180668	Steel Fold Down Side Rail, 67" PWD, Complete Kit
7180653	Steel Fold Down Side Rail, 92" PWD, Complete Kit		

ALUMINUM FOLD DOWN SIDE RAILS

Part No.	Description	Part No.	Description
7180769	Aluminum Fold Down Side Rail, 118" Kit Complete	7180774	Aluminum Fold Down Side Rail, 85" Kit Complete
7180770	Aluminum Fold Down Side Rail, 102" Kit Complete	7180805	Aluminum Fold Down Side Rail, 6" x 85" Kit Complete
7180772	Aluminum Fold Down Side Rail, 94" Kit Complete	7180775	Aluminum Fold Down Side Rail, 74" Kit Complete
7180773	Aluminum Fold Down Side Rail, 92" Kit Complete	7180768	Aluminum Fold Down Side Rail, 67" Kit Complete

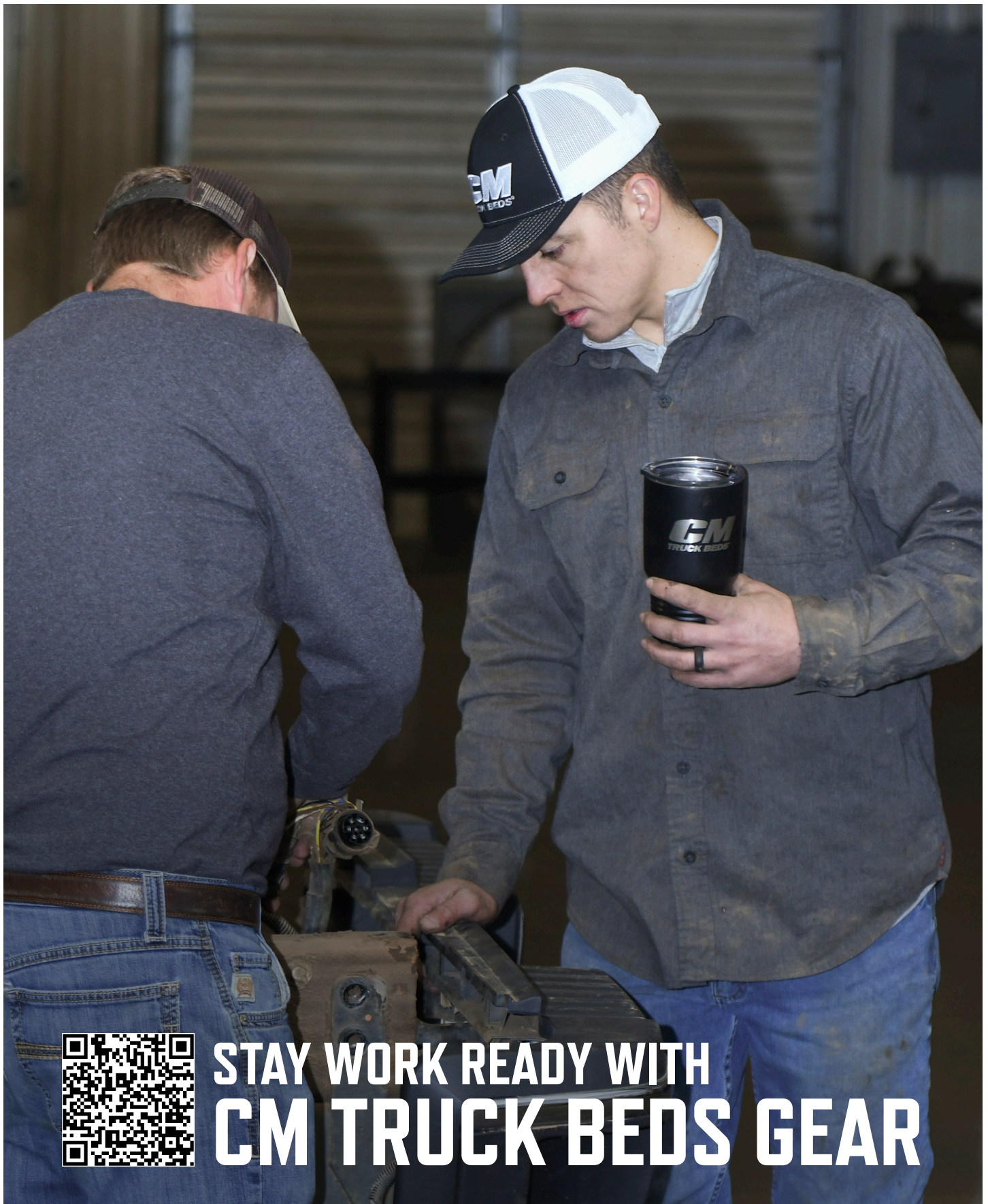

**STAY WORK READY WITH
CM TRUCK BEDS GEAR**

LIFTING EQUIPMENT



CRANES ■ HOISTS ■ HYDRAULICS

Ref. No.	Part No.	Description
1	7900348	Tiger Crane 12V Elec/Hyd Crane - 4,000 lb Capacity, 19,500 Ft Lb
2	7900353	Tiger Crane 12V Elec/Hyd Crane - 6,500 lb Capacity, 40,000 Ft Lb
3	7900029	Venco Hoist Dual Acting 516 DP Electric
4	7900199	Venco Hoist Dual Acting 620 DP Electric
5	7900259	Bale Spike mTE Power Pump
6	123660	CHIEF Bale Spike 3x10 Hydraulic Cylinder
7	7900353	1-5/8" x 47" Cast Bale Spike

INSTALLATION KITS

GM ■ FORD ■ RAM

Ref. No.	Part No.	Description	Ref. No.	Part No.	Description
1	7180522	B&W Installation Kit for GM/Chevrolet Cab & Chassis	-	5352882	B&W Installation Kit for RAM/GM
2	7180555	B&W Installation Kit for Ram Cab & Chassis	5	1080065	Universal Installation Kit
3	7180554	B&W Installation Kit for Ford Cab & Chassis	-	7181494	Universal Mounting Kit - 98" SB
4	5352592	B&W Installation Kit for Bed Delete Ford	6	7181495	Universal Mounting Kit - 110" SB
			7	7181496	Universal Mounting Kit - 134" SB

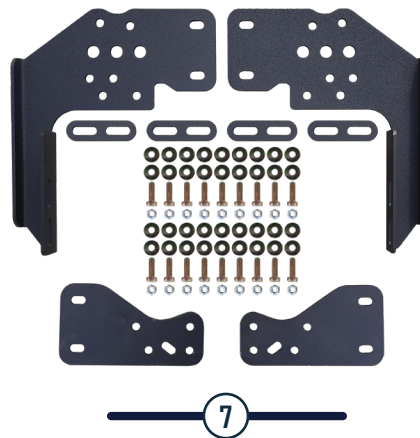
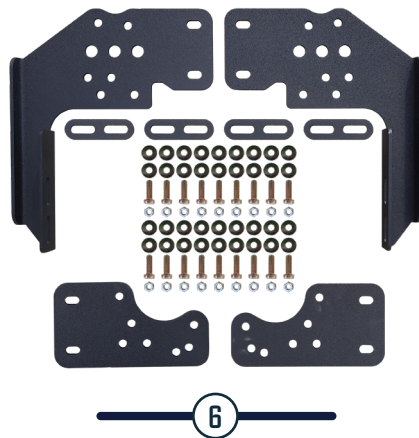
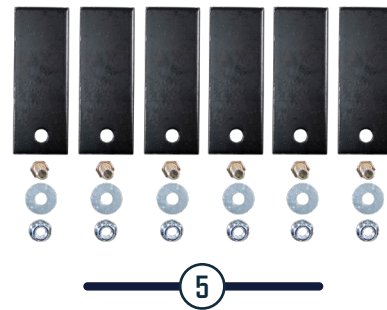

ADAPTERS

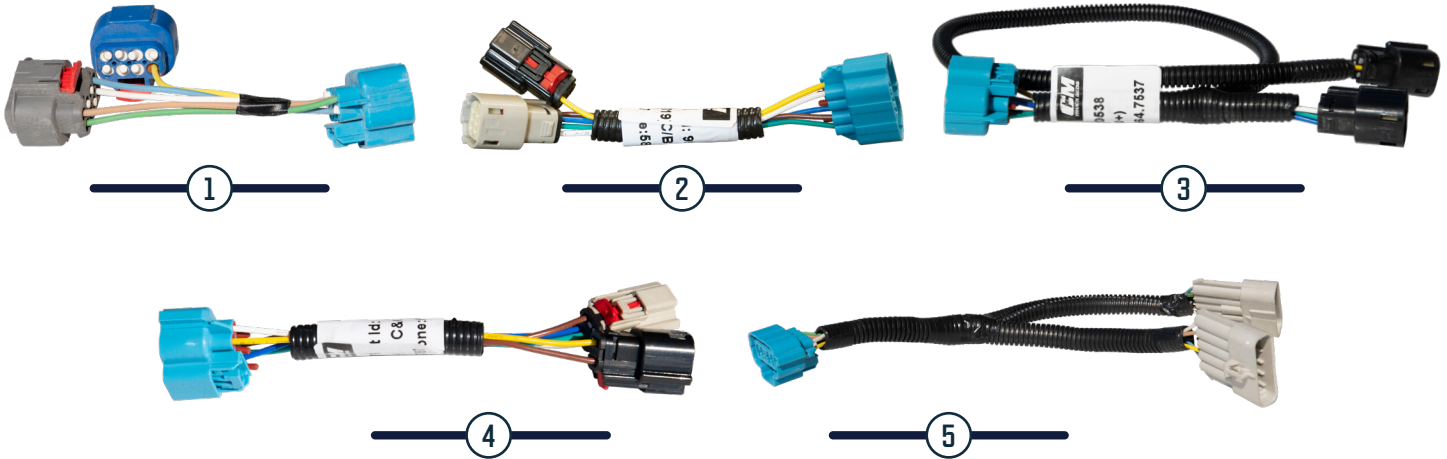

GM							
Ref No.	Part No.	Description	Model Year	Ref No.	Part No.	Description	Model Year
1	9900300	GM Cab & Chassis/Box Delete	2014-15	4	9900576	GM Cab & Chassis	2020-Present
2	9900353	GM Cab & Chassis/Box Delete	2016-2019	5	9900503	GM/International Medium Duty	2019-Present
3	9900538	GM Box Delete	2020-Present				

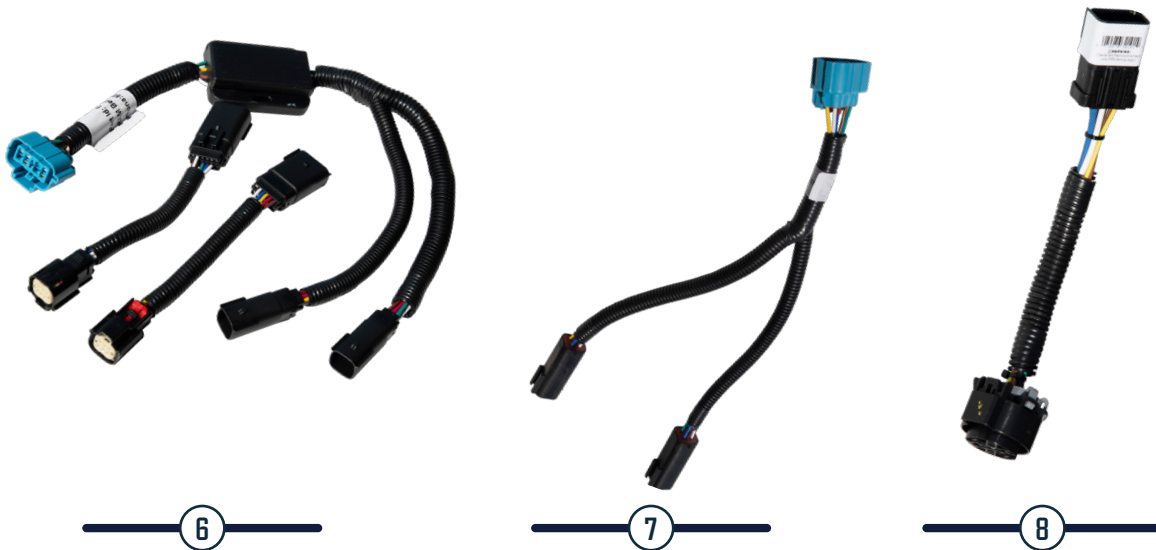

RAM			
Ref. No.	Part No.	Description	Model Year
6	9900657	RAM Box Delete	2019-Present
7	9900307	RAM Cab & Chassis	2011-Present
8	9900273	RAM 7-Pin Trailer Plug	1993-2009

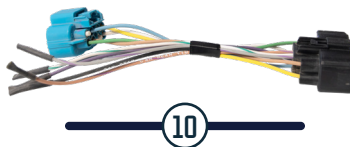
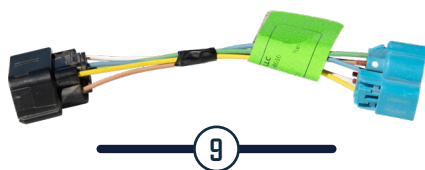

FORD

Ref No.	Part No.	Description	Model Year	Ref No.	Part No.	Description	Model Year
9	9900308	Ford Box Delete WITHOUT factory camera	2011-16	12	9900564	Ford Box Delete with Converter	2020-Present
10	9900425	Ford Box Delete WITH Factory Camera	2011-2016	13	9900306	Ford Cab & Chassis	1999-Present
11	9900426	Ford Box Delete	2017-2019	14	9900593	Ford Cab & Chassis for Trailer Tow	2020-Present

WIRING HARNESSES



CM TRUCK BEDS WIRING HARNESSES

Ref No.	Part No.	Description	Ref No.	Part No.	Description
15	9900474	Main Insulated Harness 98"	19	7001119	OEM Plug to 7-4 Way Socket Assembly with CMTB Logo
16	9900472	Rear Insulated Harness	20	7000789	Hopkins Plug 7-4 Way Socket Assembly
17	116676-B	Headache Rack Insulated Harness	21	9900450	+/- 26A Hydraulic Pump Harness with 200 Amp Breaker
18	119905	GN Trailer Plug & Harness			

GENERAL ELECTRICAL WIRING

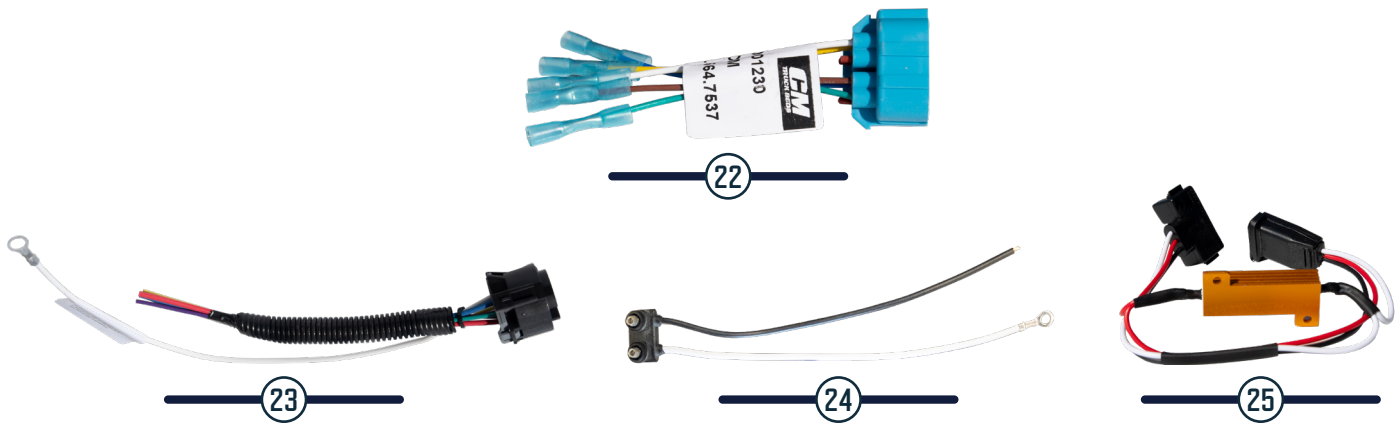

BARE WIRES ■ RESISTORS		
Ref No.	Part No.	Description
22	7001230	CM Female Receptacle with Bare Wires
23	9900274	Female Universal Trailer Tow with Bare Wire
24	8100383	2 Pin Plug with 10" Lead
25	8101425	12 Volt LED Resistor

A black CM Truck Beds bag and a black and white CM Truck Beds cap are sitting on the metal bed of a truck. In the background, a red barn and a green tractor are visible.



GET WORK READY WITH
CM TRUCK BEDS GEAR

HITCHES

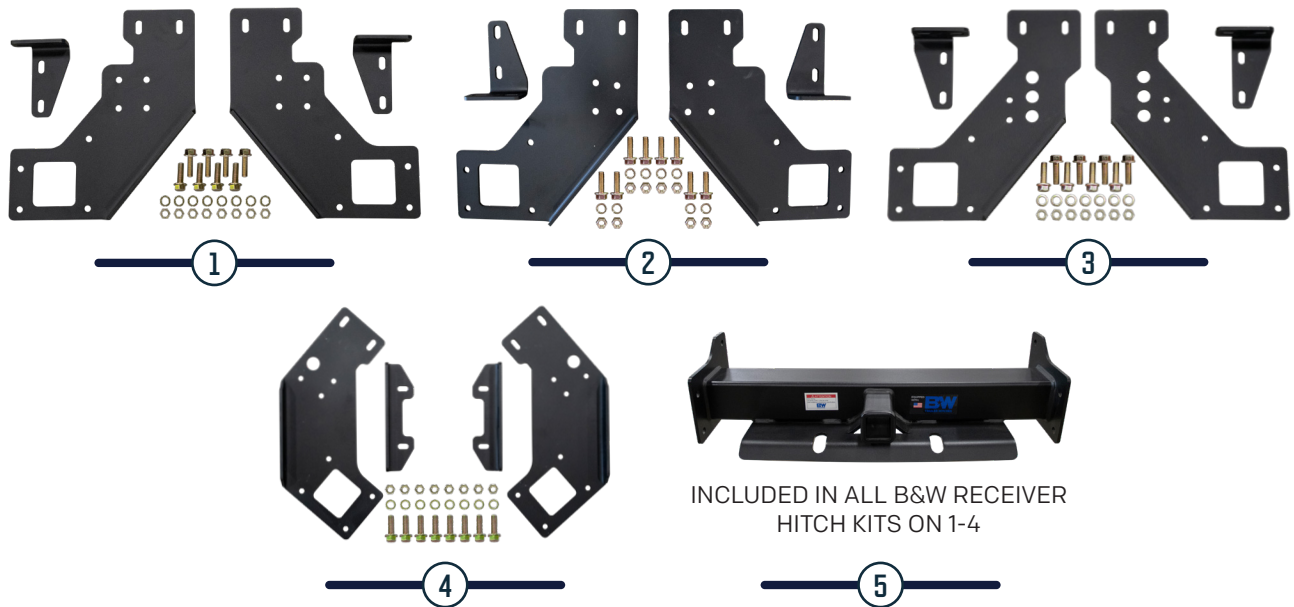

SERVICE BODY HITCHES

Ref No.	Part No.	Description	Ref No.	Part No.	Description
1	7352074	B&W Receiver Hitch Kit for Ram Cab & Chassis - 18.5K lb	3	7352075	B&W Receiver Hitch Kit for GM Cab & Chassis - 18.5K lb
-	7181633	B&W Receiver Hitch Kit for Ram Cab & Chassis - 24K lb	-	7181632	B&W Receiver Hitch Kit for GM Cab & Chassis - 24K lb
2	7352073	B&W Receiver Hitch Kit for Ford Cab & Chassis - 18.5K lb	4	7181581	B&W Receiver Hitch Kit for GM Medium Duty - 18.5K lb
-	7181634	B&W Receiver Hitch Kit for Ford Cab & Chassis - 24K lb	-	7181490	B&W Receiver Hitch Kit for GM Medium Duty - 24K lb
			5	-	Replacement Unit Only



5TH WHEEL ■ ICC BUMPERS ■ TURNOVER BALLS

No.	Part No.	Description	No.	Part No.	Description
6	7350563	B&W 5th Wheel Companion - 18K to Turnover Hitch	-	7181176	GM 3500 B&W CT Series Bumper/Hitch - 24K lb. 2 1/2" Receiver Tube
-	7350897	B&W 5th Wheel Companion - 22K to Turnover Hitch	-	7181174	RAM B&W ICC Bumper/Hitch - 18.5K lb. with 2" Receiver Tube
7	7350608	CURT Spyder 5th Wheel - 30K - Used for HS Hotshot Bodies	-	7181178	RAM B&W Contractor Series Bumper/Hitch - 24K lb. with 2 1/2" Receiver Tube
8	7350609	CURT Spyder 2 1/8" Gooseneck - 30K - Used for HS Hotshot Bodies	-	7181171	GM Medium Duty B&W ICC Bumper/Hitch - 18.5K lb. with 2" Receiver Tube
9	7181173	Ford B&W ICC Bumper/Hitch - 18.5K lb with 2" Receiver Tube	-	7181175	GM Medium Duty B&W Contractor Series Bumper/Hitch - 24K lb. 2 1/2" Receiver Tube
10	7181177	Ford B&W Contractor Series Bumper/Hitch - 24K lb 2 1/2" Receiver Tb.	11	7350551	2 1/8" B&W 30K lb B&W GN Turnover Ball
-	7181172	GM 3500 B&W ICC Bumper/Hitch - 18.5K lb with 2" Receiver Tube			

TOOLBOX EQUIPMENT



1



2



3

CTECH TOOLBOXES

No.	Part No.	Description	Dimensions	No.	Part No.	Description	Dimensions
1	7181120	CTech 6 Drawer for 8'6"/9'4" DRW TM/TM Deluxe	29 13/16" X 29" X 16 1/2"	-	9451359	CB/SB 11078 RV Gen II - 6 Drawer	30" x 20" x 11"
-	7181121	CTech 2 Drawer for 8'6"/9'4" SRW TMX	29 9/16" X 29" X 13"	-	9451360	CB/SB 13494 All Verticals and 11094 RV Gen II - 6 Drawer	30" x 20" x 19"
2	7181608	CTech 6 Drawer Mega Box for 11'4" TM/TM Deluxe	50" X 28" X 15 1/2"	-	9451363	CB/SB 7878/8178/8278/9878 Vpack HZ Gen II - 2 Drawer	11" x 37" x 10"
-	9451346	CB/SB 9878 FV Gen II - 4 Drawer	30" x 24" x 11"	-	9451367	CB/SB 9894 Vpack HZ Gen II - 2 Drawer	11" x 37" x 18"
-	9451349	CB/SB 9894 FV Gen II - 6 Drawer	30" x 24" x 19"	-	9451368	CB/SB 11078 Vpack HZ Gen II - 2 Drawer	11" x 44" x 10"
-	9451353	CB/SB 7678/8178 RV Gen II - 4 Drawer	28" x 12" x 11"	-	9451369	CB/SB 11094/13494 Vpack HZ Gen II - 2 Drawer	11" x 44" x 18"
-	9451354	CB/SB 8278/9878 RV Gen II - 5 Drawer	30" x 15" x 11"	-	9451371	Crane Body 20K Capacity FV - 6 Drawer	34" x 25" x 18"
-	9451355	CB/SB 9894 RV Gen II - 6 Drawer	30" x 15" x 19"	-	9451372	Crane Body 40K Capacity Street Side FV - 6 Drawer	34" x 28" x 18"
-	9451356	CB/SB 11078 FV Gen II - 6 - Drawer	30" x 24" x 11"	-	9451373	Crane Body 20K Capacity Street Side RV - 6 Drawer	34" x 19" x 18"
-	9451357	CB/SB 11094 FV Gen II - 6 Drawer	30" x 24" x 19"	-	9451374	Crane Body 40K Capacity Street Side RV - 3 Drawer	15" x 38" x 18"
-	9451358	CB/SB 11094 WITH DEF FV Gen II - 6 Drawer	30" x 24" x 19"	-	9451376	Crane Body 40K & 20K Capacity HZ - 3 Drawer	15" x 38" x 18"

AMERICAN EAGLE TOOLBOXES

No.	Part No.	Description	Dimensions	No.	Part No.	Description	Dimensions
3	9450793	Red 6 Drawer Rollout for Standard TM	28 1/2" x 26" x 16"	-	9451523	Red 6 Drawer for the Megabox for the TM DLX or SK DLX	28 1/2" x 50" x 16"
				-	9451524	Red 2 Drawer Rollout for the TMX	10 1/2" x 25" x 12"
				-	5353579	Riser Kit - Works with P#9451524	19 1/2" x 8"



EQUIPTO DRAWERS

No.	Part No.	Description
1	7181347	Kit, 11078, Horizontal, Equipto - Gen II
2	7181346	Kit, 11078, Rear Vertical, Equipto - Gen II
3	7181345	Kit, 11094, Horizontal, Equipto - Gen II
4	7181344	Kit, 11094, Rear Vertical, AND 13494, All Vertical, Equipto - Gen II
5	7181343	Kit, 9878 & 11078, 1st Vertical, Equipto - Gen II
6	7181342	Kit, 9894, 11094 1st Vertical, Equipto - Gen II
7	7181341	Kit, 9878, Horizontal, Equipto - Gen II
8	7181340	Kit, 9894, Horizontal, Equipto - Gen II

FLIP TOP COMPARTMENTS

No.	Part No.	Description
1	7181154	Top, 11078, Flip - Gen II Loose
2	7181326	Top, 11094, Flip - Gen II Loose
3	7181323	Top, 13494, Flip - Gen II Loose
4	7181324	Top, 7678, Flip - Short Box RAM - Gen II Loose
5	7180843	Top, 8178, Flip - Short Box GM - Gen II Loose
6	7181322	Top, 8278, Flip - Short Box Ford - Gen II Loose
7	7181321	Top, 9878, Flip - Gen II Loose
8	7181320	Top, 9894, Flip - Gen II Loose



KARGOMASTER LADDER RACK

No.	Part No.	Description
1	7181568	Kargo Master, Rails, Extended Cab, 8' Black, Require 7181565
2	7181570	Kargo Master, Rails, Extended Cab, 9' or 11' Black, Require 7181565
3	7181567	Kargo Master, Rails, Standard Cab, 8' Black, Require 7181565
4	7181565	Kargo Master, Legs and Bars
5	7181572	Kargo Master, Window Guard
6	7181573	Kargo Master, Ratchet Strap with Mounts
7	7181576	Kargo Master, Utility Hook
8	7181577	Kargo Master, Emergency Light Mount BRKT
9	7181578	Kargo Master, Emergency Light - Amber



TOOLBOX SHELVING					
No.	Part No.	Description	No.	Part No.	Description
1	7180552	Shelf, Galv. Upper Cabinet for 8'6" - 9'4" DRW TM	3	7181052	Shelf, Galv. Lower Cabinet for 11'4" TM
2	7180553	Shelf, Galv. Lower Cabinet for 8'6" - 9'4" DRW TM	4	7181053	Shelf, Galv. Upper Cabinet for 11'4" TM



LATCHES ■ HINGES ■ CABLES ■ WEATHERSTRIPPING ■ SPRINGS								
No.	Part No.	Description	No.	Part No.	Description	No.	Part No.	Description
1	8200546	Stainless Steel Paddle/Scissor Latch	6	8200725	Stainless Steel Paddle Latch Rotary	11	9460091	Edging Weatherstrip Flat Seal
2	8200598	Stainless Steel Scissor Latch for TM Tailgate	7	122588	DS Left Hand Bullet Spring Latch	12	7300158	30 lb Gas Shock
3	8200905-B	T Handle Comp Latch w/Chrome CMTB Logo	8	122587	PS Right Hand Bullet Spring Latch	-	119324	90 lb Gas Shock
4	8200959	T Handle Comp Latch w/Full Black No Logo	9	122552	TB SS Door Hinge (ER Door Hinge)			
5	8201054	Latch T Handle Composite, Chrome, No Logo	10	945007	TB Toolbox Cable 13 ½" - Eye to Eye			

DOORS & FABRICATED ASSEMBLIES

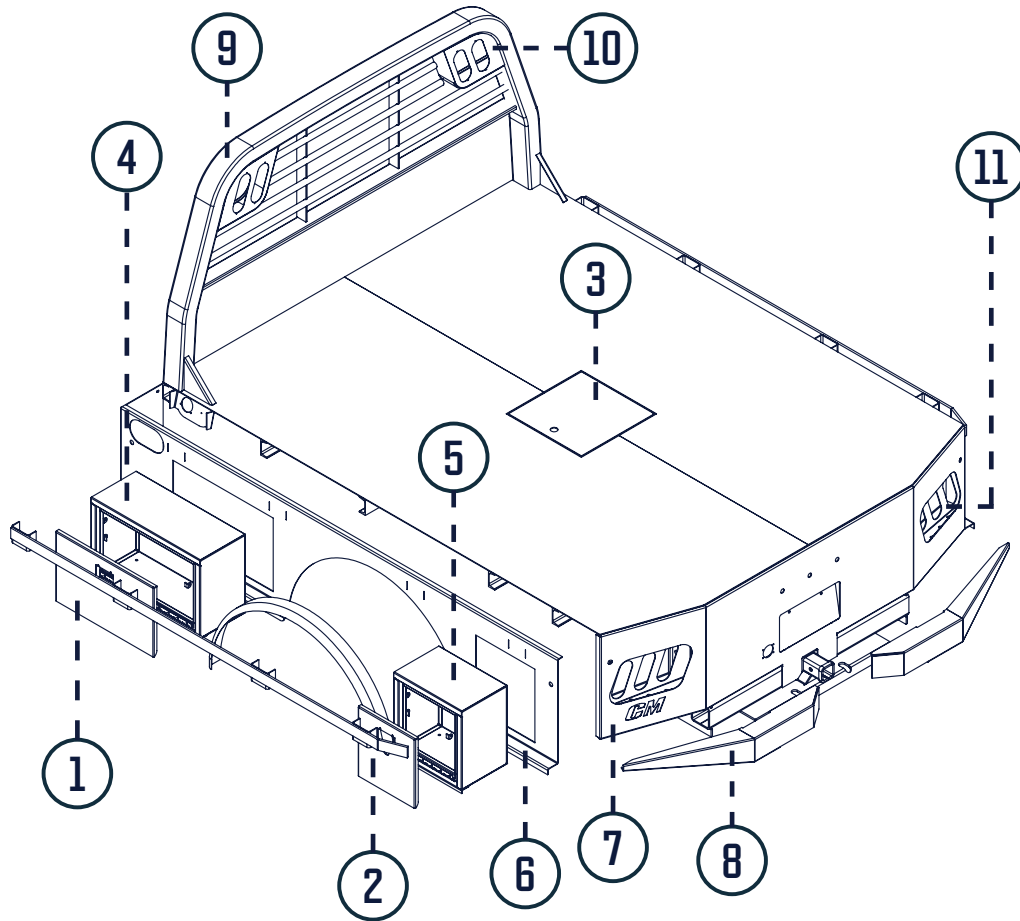

SK SKIRTED BODY PIECES

Ref. No.	Description	Ref. No.	Description
1	Front Compartment Door for 15", 24", 36", or 48" Toolboxes - All Sizes are 15" Tall	6	Drivers Side or Passengers Side Skirt for 84", 8'6", 9'4", or 11'4" lengths
2	Rear Compartment Door for 15" or 18" Toolboxes - All Sizes are 15" Tall	7	Rear Skirt for 84", 92", 94", or 97" widths
3	GN Cover Lid	8	Bumper Wing for 84", 92", 94" or 97" widths - Driver or Passenger Side
4	Front Compartment for 15", 24", 36" or 48" Toolboxes - 10" Depth	-	Running Board Kit - 84", 8'6", 9'4" or 11'4" lengths - DRW or SRW
-	Front Compartment for 15", 24", 36" or 48" Toolboxes - 13" Depth	-	Steel Fender - Reference Fender Page 2
5	Rear Compartment for 15" or 18" Toolboxes - 10" Depth	9	Headache Rack Assembly - GM, Regular, SD, or GMSD - DRW or SRW
-	Rear Compartment for 15" or 18" Toolboxes - 13" Depth	10	Headache Rack Light Housings - Driver or Passenger Side
		11	Rear Light Housing - Driver or Passenger Side

DOORS & FABRICATED ASSEMBLIES

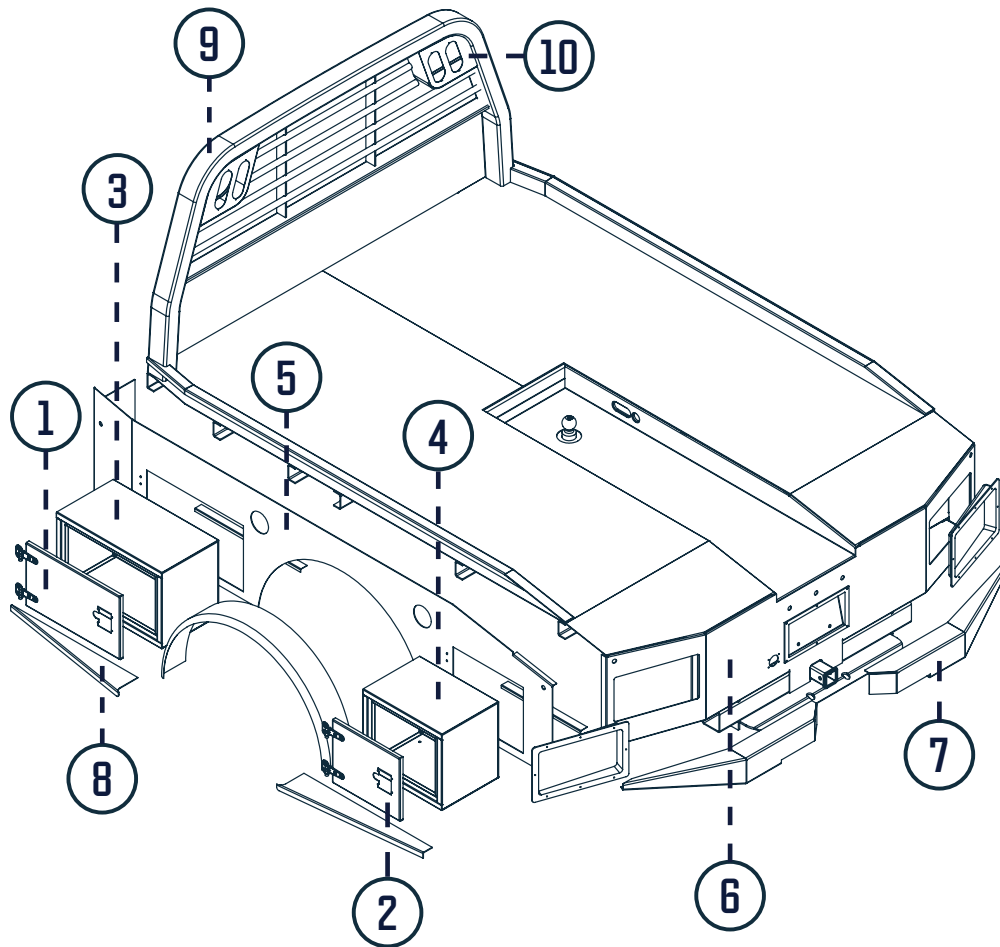

ER HAULER BODY PIECES

Ref. No.	Description	Ref. No.	Description
1	Front Compartment Door for 15", 24" or 36" Toolboxes - All Sizes are 15" Tall	6	Rear Skirt for 84", 92", 94", or 97" widths
2	Rear Compartment Door for 15" or 18" Toolboxes - All Sizes are 15" Tall	7	Bumper Wing for 84", 92", 94" or 97" widths - Driver or Passenger Side
3	Front Compartment for 15", 24" or 36" Toolboxes - 10" Depth	8	Running Board Kit - 84", 8'6", 9'4" or 11'4" lengths - DRW or SRW
-	Front Compartment for 15", 24" or 36" Toolboxes - 13" Depth	9	Headache Rack Assembly - GM, Regular, SD, or GMSD - DRW or SRW
4	Rear Compartment for 15" or 18" Toolboxes - 10" Depth	10	Headache Rack Light Housings - Driver or Passenger Side
-	Rear Compartment for 15" or 18" Toolboxes - 13" Depth	-	Rear Light Housing - Driver or Passenger Side - Reference Page 2
5	Drivers Side or Passengers Side Skirt for 84", 8'6", 9'4", or 11'4" lengths	-	Stainless Steel Fender - Reference Page 2

DOORS & FABRICATED ASSEMBLIES

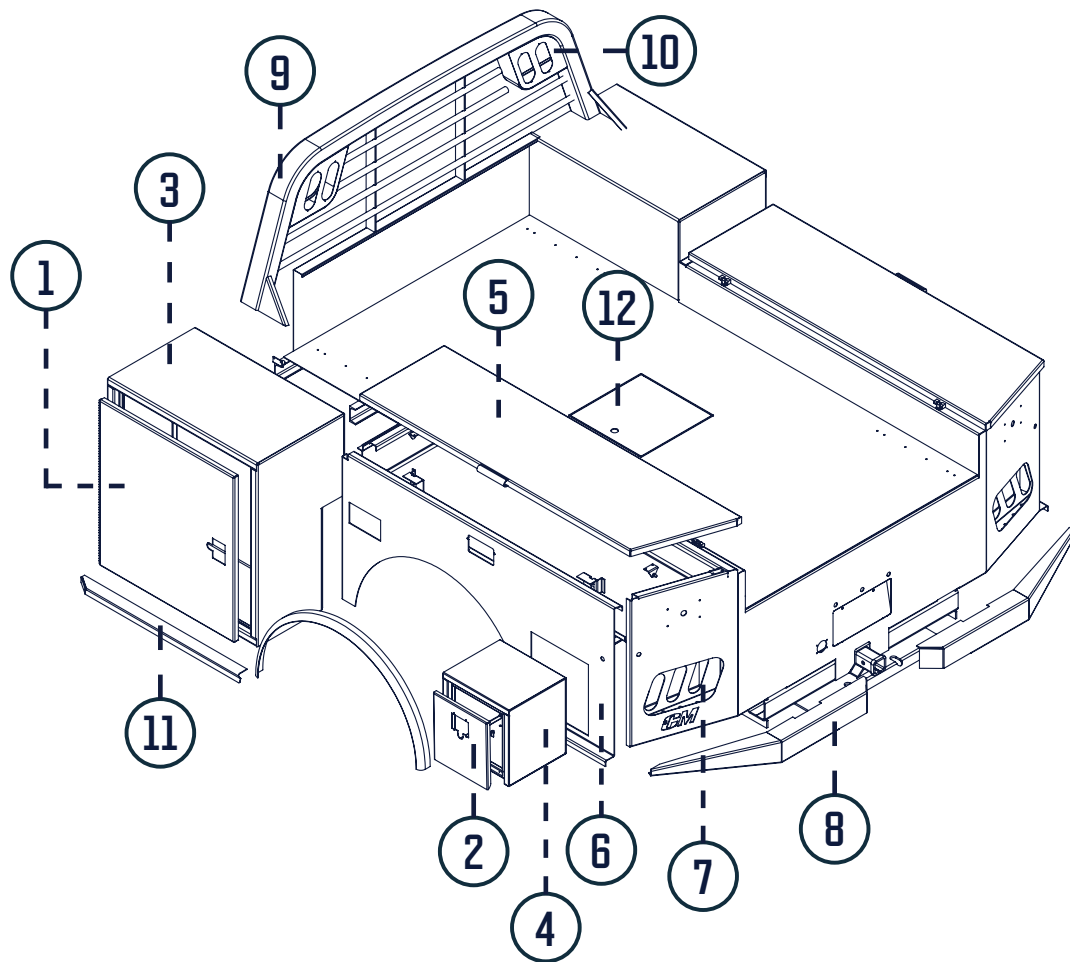

TM TRADESMAN BODY PIECES

Door No.	Description	Door No.	Description
1	Drivers Side or Passengers Side Front Compartment Door	7	Rear Light Housing - Driver or Passenger Side
2	Rear Compartment Door for 15" or 18" Toolboxes - All Sizes are 15" Tall	8	Bumper Wing for 84", 94" or 97" widths - Driver or Passenger Side
3	Front Compartment for 84", 94", or 97" Wide Bodies	9	Headache Rack Assembly - GM, Regular, SD, or GMSD - DRW or SRW
4	Rear Compartment for 15" or 18" Toolboxes - 10" Depth	10	Headache Rack Light Housings - Driver or Passenger Side
-	Rear Compartment for 15" or 18" Toolboxes - 13" Depth	11	Running Board Kit - 84", 8'6", 9'4" or 11'4" lengths - DRW or SRW
5	Drivers Side or Passengers Side Shovel Box Compartment Door - SRW or DRW	-	Steel Fender - Reference Fender Page 2
6	Drivers Side or Passengers Side Skirt for 84", 8'6", 9'4", or 11'4" lengths	12	GN Cover Lid

DOORS & FABRICATED ASSEMBLIES

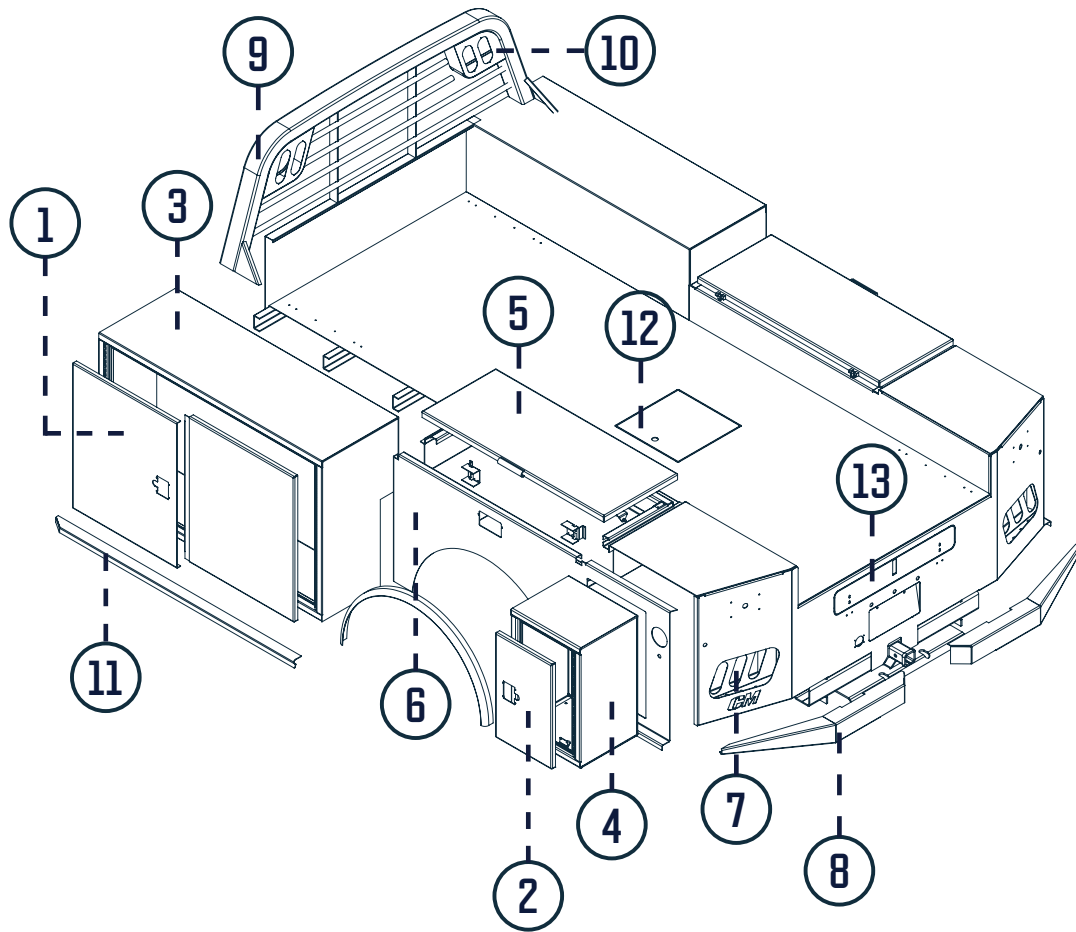

TM DELUXE TRADESMAN BODY PIECES

Door No.	Description	Door No.	Description
1	Drivers Side or Passengers Side Front Compartment Door - Variable Width	8	Bumper Wing for 84", 94" or 97" widths - Driver or Passenger Side
2	Drivers Side or Passengers Side Rear Compartment Door - 27" T x 18"W	9	Headache Rack Assembly - GM, Regular, SD, or GMSD - DRW or SRW
3	Drivers Side or Passengers Side Front Compartment - Variable Width	10	Headache Rack Light Housings - Driver or Passenger Side
4	Rear Compartment - 27" T x 18"W x 15"D	11	Running Board Kit - 84", 8'6", 9'4" or 11'4" lengths - DRW or SRW
5	Drivers Side or Passengers Side Shovel Box Compartment Door	12	GN Cover Lid
6	Drivers Side or Passengers Side Skirt for 84", 8'6", 9'4", or 11'4" lengths	13	Opposum Belly Door
7	Rear Light Housing - Driver or Passenger Side	-	Steel Fender - Reference Fender Page 2

DOORS & FABRICATED ASSEMBLIES

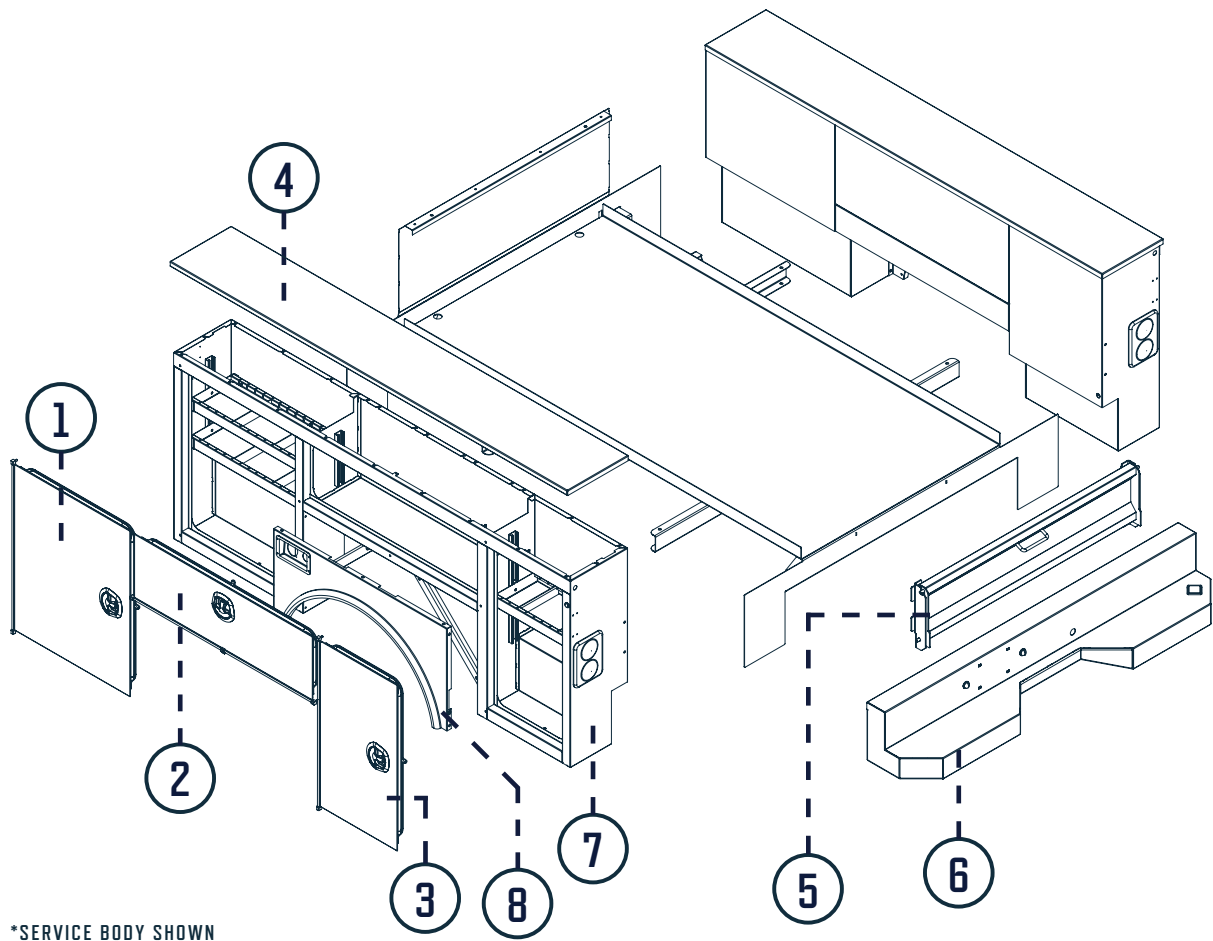

SB/CB SERVICE BODY PIECES

Ref. No.	Description	Ref. No.	Description
1	Front First Vertical Door - 98", 110" or 134"	6	Rear Bumper without Lights and Vice Mount - SRW or DRW
2	Wheelwell Horizontal Door - 98", 110" or 134"	-	Rear Bumper with Lights and Vice Mount - SRW or DRW
3	Rear Vertical Door - 98", 110" or 134"	7	Streetside Steel/Aluminum Sidepack - 98", 110" or 134"
4	Standard Aluminum/Steel Sidepack Top - 98", 110" or 134"	-	Curbside Steel/Aluminum Sidepack - 98", 110" or 134"
-	Optional Aluminum Fliptop - 98", 110" or 134"	8	Streetside Fenderette with Front Fuel Fill and DEF Cutout - 98", 110" or 134"
5	Steel/Aluminum Tailgate with Latch	-	Curbside Fenderette with No Cutout - 98", 110" or 134"

KEEPING YOU
#WORKREADY



CM
TRUCK BEDS®

CMTRUCKBEDS.COM

580.564.7537

WORK READY